



GREEN  
PALMS



*Nature Inspired Living*

Environment - friendly residential units for enviro - conscious people. apart from being located in city's most serene and cream area, layout, landscaping, architectural and interior design fully loaded with the state-of-the art amenities create a perfect match for joyous living.

ENVIRO - FRIENDLY  
*Atmosphere*



SUPERIOR  
*Signature*  
OF NATURE

Amidst lush green legacies of nature and where you hear your mind think lies Green Palms. Nothing short of picturesque beauty and dreams capes.



Entrance Gate



Gated Security



C.C.T.V. Camera



NATURE'S  
*Delicacies*  
JUST LIKE YOUR DREAM

It is a multicolored canvas that unveils your life's fresh new landscape. It is a gateway towards your dreams.



# Natural Living

## THE BEAUTY OF ARCHITECTURE

Green Palms is a creation, something that has a personality and an impressive piece of art. Using different shapes, colors and materials, we have offered architectural pieces that could also serve as landmark, over and above residences.



REFRESHING NATURAL

## Ambience

FOR BODY & SOUL

Green ambience is being introduced for the nature loving people





TYPICAL LAYOUT PLAN - RESIDENTIAL





GROUND FLOOR PLAN - COMMERCIAL



FIRST FLOOR PLAN - COMMERCIAL



## UPPER & LOWER BASEMENT FLOOR PLAN

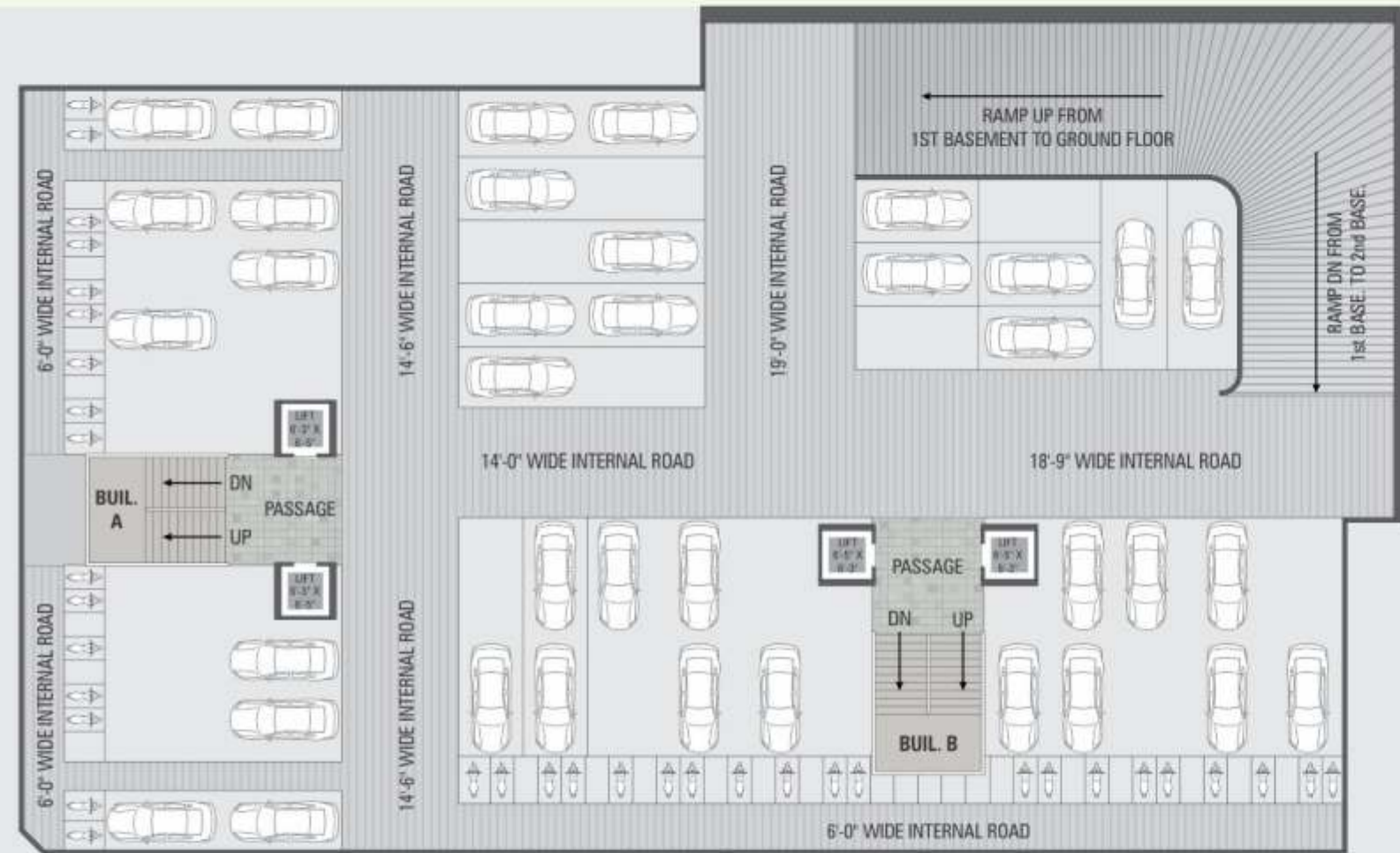

# SPECIFICATION

## INTERNAL SPECIFICATION

### FLOORING

32"x48" granamite tiles in living, dining and kitchen.  
32"x32" granamite tiles in bedroom.

### KITCHEN

Granite kitchen platform with full height tile dedo.

### STORE ROOM

Kota stone racks with tile dedo of standard quality

### BATHROOM

Anti skid granamite tile flooring with well designed wall tiles.

### PLUMBING

ISI brand CPVC/UPVC pipes for water supply and drainage. Flat wise central plumbing system for hot water supply. Branded CP and sanitary fittings.

### ELECTRIFICATION

Branded copper wiring with ISI modular switches. Centralized TV and internet point.

### DOORS AND WINDOWS

Wooden main door. Internal flush doors with standard hardware fittings. Anodized aluminum sliding windows with reflective glass of standard quality.

### WALL FINISH

Plaster with putty finish

## EXTERNAL FINISHES

Two coat sand faced finished plaster with texture finish  
Chemical water proofing in terrace with china mosaic flooring.

## COMMON FACILITIES

### GENERATOR BACKUP

Power backup for common area lighting and elevator.  
Backup for each flat having enough electrical points except AC and refrigerator.

### PARKING

Double Basement Parking.

### WATER SUPPLY

SMC water supply and bore well.

### SECURITY SYSTEM

CCTV camera surveillance and security cabin

### ROAD NETWORK

RCC/Paver block road of good quality

### FIRE SAFETY

Fire security system as per NBC norms.

## COMMON AMENITIES

Children play area  
Senior citizen gazebo and other sit out places

18.00 MT. WIDE ROAD

15.00 MT. WIDE ROAD





